

The bearing & Distances
up the River are

- N. 70 W. 35
- N. 40 W. 56
- N. 22 W. 62
- N. 37 W. 49.

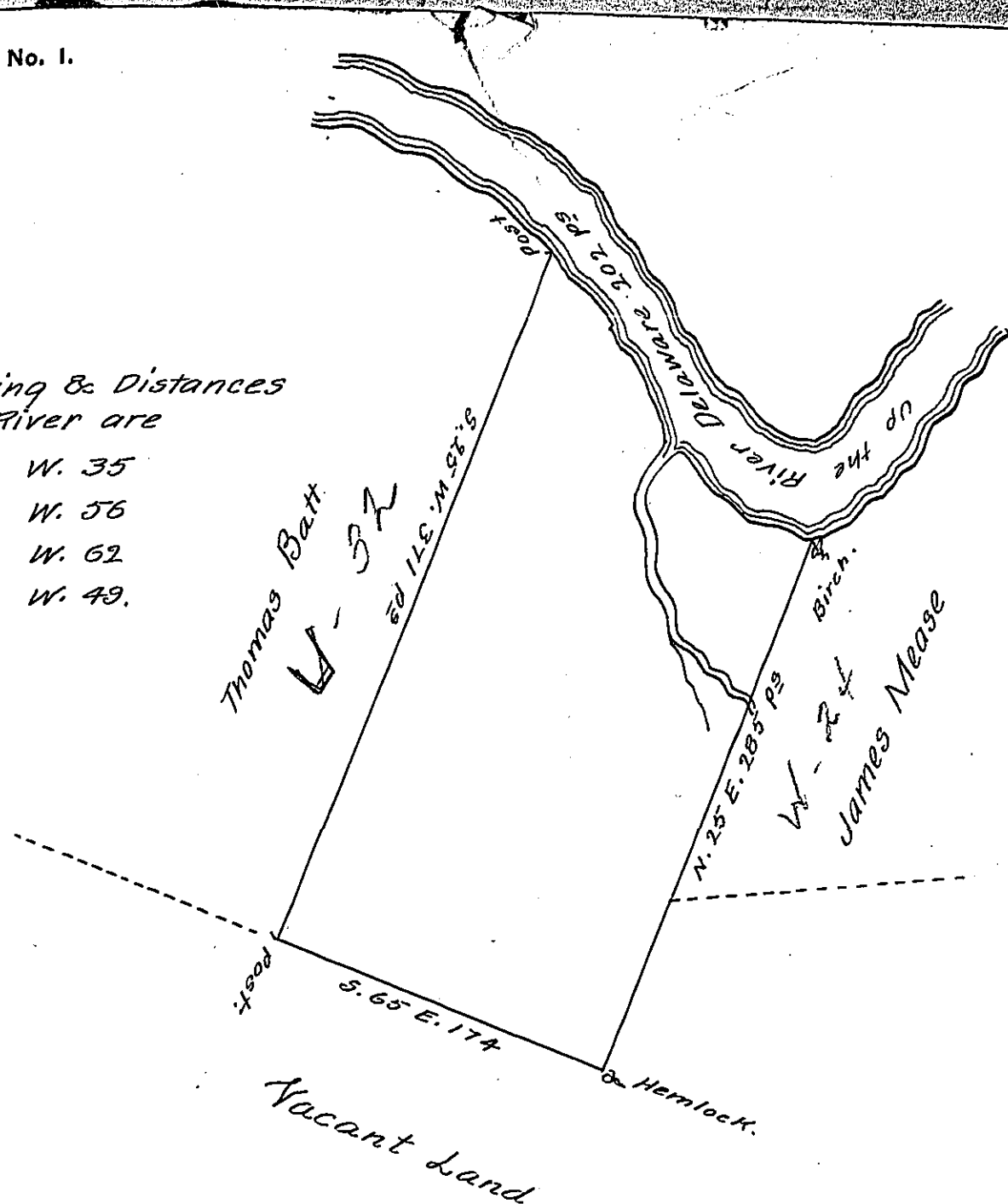

By Virtue of a Warrant Dated the 17th Day of March
 1774 Surveyed the 21st Day of June 1775 to Matthew Mease the
 above Described tract of Land situate on the West side of the River
 Delaware about Nineteen miles & an half above Station Rock in No-
 rthampton County Containing Three hundred and twenty four Acr-
 es an hundred and fifty perches and the allowance of Six P. Cent
 &c^a

P. Geo. Palmer D.S.

To John Lukens Esq^r.
 Surveyor General.

IN TESTIMONY that the above is a copy of the original remaining on file in
 the Department of Internal Affairs of Pennsylvania, made
 conformably to an Act of Assembly approved the 16th day of
 February, 1833, I have hereunto set my Hand and caused
 the Seal of said Department to be affixed at Harrisburg,
 this twenty-third day of November 1905.

George R. Brown
 Secretary of Internal Affairs.